

sector 111

READ FITTING INSTRUCTIONS IN FULL BEFORE INSTALLATION

This article is sold without warranty expressed or implied. No warranty or representation is made as to this product's ability to protect the user from injury or death. The user assumes that risk. The effectiveness, warranty and longevity of this equipment are directly related to the manner in which it is INSTALLED, USED, and/or MAINTAINED. THE USER ASSUMES THE RISK.

By purchasing this product and opening the packaging, purchasers expressly acknowledge, understand and agree that they take, select and purchase these SECTOR 111 products from SECTOR 111, its affiliates, distributors, and agents (collectively, SECTOR 111) **as is** and **with all faults**.

The entire risk as to the quality and performance of these SECTOR 111 parts is with the purchasers. Working on your car can be a dangerous activity. If you are unsure of what you are doing, please leave mechanical or Safety critical work to a skilled mechanic.

We take no responsibility for the incorrect use and/or installation of SECTOR 111 products.

1. Disconnect Battery

- 10mm Wrench

- a. Locate battery in trunk.
- b. Remove plastic battery cover.
- c. Disconnect positive and negative battery terminals.



hubQR2 with SRS Module Installation Instructions Rev C

Rev. B

Page 2 of 10

Assembly Step

Tools/ Parts

Detailed Instructions

Picture

2. Remove Air Bag

- Flat Head Screwdriver
- 5mm Allen Wrench

- a. Make sure wheels are straight forward.
- b. Remove two 5mm Allen bolts located on the sides of the OEM steering wheel.
- c. Pull the airbag assembly from out of the center of the OEM steering wheel.

- d. Use a flat head screwdriver to remove the green safety clip located on the back of the airbag assembly.
- e. Pull SRS plug from airbag assembly.
- f. Pull horn plug from steering wheel harness.

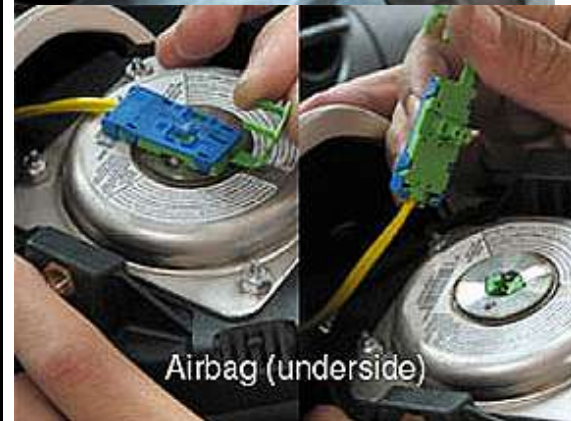

hubQR2 with SRS Module Installation Instructions Rev C		Rev. B	Page 3 of 10
Assembly Step	Tools/ Parts	Detailed Instructions	Picture

3. Remove Factory Steering Wheel	<ul style="list-style-type: none"> • 5mm Allen Wrench 	<ol style="list-style-type: none"> Remove (4) 5mm Allen bolts located inside center of OEM steering wheel. Pull wheel off from steering column. 	
4. Horn Wiring	<ul style="list-style-type: none"> • Wire Cutters • Crimps (Optional) • Soldering Iron • Wire Strippers 	<ol style="list-style-type: none"> For the following steps, refer to wiring diagram on page 13. Inside OEM steering wheel, you will need to cut and reuse the female plug from the horn leads (be sure to leave enough wire length to strip and crimp). You can either solder these wires together (for permanent install) or get quick disconnects. If you choose to solder the wires permanently, then skip steps "e" & "f" and solder directly to the female horn harness plug. If you choose to get quick disconnects, you need a 	

hubQR2 with SRS Module Installation Instructions Rev C		Rev. B	Page 4 of 10
Assembly Step	Tools/ Parts	Detailed Instructions	Picture

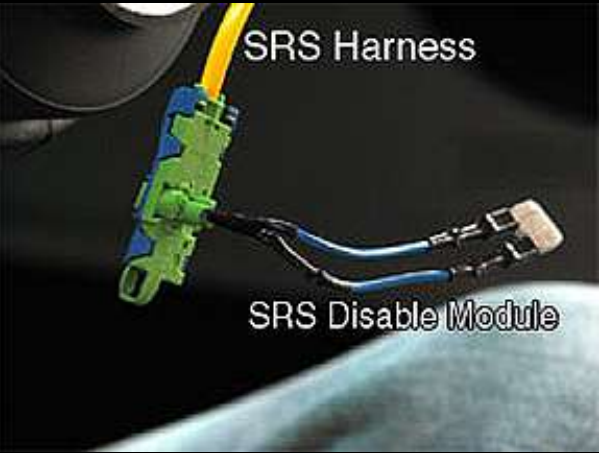
		<p>ground (-) male crimp-on quick disconnect as well as a power (+) female crimp-on quick disconnect (these can be found in your local electronics store).</p> <p>f. Crimp the 2 quick disconnects onto the OEM female plug wire that you cut in step “b”.</p>	
5. SRS Bypass	<ul style="list-style-type: none"> SRS Airbag Disable Module 	<p>a. Take the SRS Airbag Disable Module and plug into the green SRS plug jumper.</p> <p>b. Note: Keep in mind that since it is a fuse, positive and negative do not apply.</p>	

hubQR2 with SRS Module Installation Instructions Rev C

Rev. B

Page 5 of 10

Assembly Step

Tools/ Parts

Detailed Instructions

Picture

6. Install Hub Adapter

- Hub Adapter
- 5mm Allen Socket
- Extension
- Torque Wrench

- Remove short hub from package and take off the plastic hub shroud.
- On top of the short hub, there is an indented “dot” which indicates “12 o’clock” position on the hub.
- Align hub dot at 12 o’clock position and put in the 4 bolts from Step 3.
- Torque bolts down in a cross pattern with ~25-30 ft. lbs torque.
- Put plastic hub shroud back over the hub if desired.



Note: Image shown is NOT the HUBgtc. Image is used as reference only

7. Install hubQR(Steering Wheel Side)

- hubQR(Steering Wheel Side)
- Grounding Ring

- Attach hubQR(steering wheel side) to the hubQR (hub side) and lock in place.
- Note: Picture does not show Flipper in place.



hubQR2 with SRS Module Installation Instructions Rev C		Rev. B	Page 6 of 10
Assembly Step	Tools/ Parts	Detailed Instructions	Picture

		<ul style="list-style-type: none"> c. Take included grounding ring (taped to cardboard packaging) and place with the prong at 12 o'clock position. d. Connect black ground wire from hubQR (wheel side) to the grounding ring prong. e. Bend prong down so that the horn button can fit. 	
8. Install Steering Wheel of Choice	<ul style="list-style-type: none"> • Steering Wheel of Choice (Personal F1 Wheel Pictured) • Steering Wheel Mounting Screws (Supplied With Steering Wheel) 	<ul style="list-style-type: none"> a. Take the 6 bolt steering wheel of your choice and bolt it to the hubQR (Personal F1 Steering Wheel Pictured) b. Torque down steering wheel bolts in a star pattern to ~15ft. lbs. torque. 	

hubQR2 with SRS Module Installation Instructions Rev C

Rev. B

Page 7 of 10

Assembly Step

Tools/ Parts

Detailed Instructions

Picture

9. Install Horn Button (If Applicable)

- Horn Button (If Applicable)

- a. If your steering wheel includes a horn button, attach the power (yellow) wire to the horn.
- b. Put horn button inside hubQR.
- c. Note: hubQR has a silver metal ring inside that may need to be removed for some horn buttons. Horn button is a tight fit and will require adequate pressure to install. Be sure to line it up prior to fully installing.



10. Test Horn

- 10mm Wrench

- d. Re-connect battery.
- e. Test horn.
- f. Cover battery when you verify the horn works.

Assembly Step

Tools/ Parts

Detailed Instructions

Picture

11. Wheel Removal and Installation

- a. Since the hubQR is machined with very precise tolerance, incorrect usage of the mechanism can hinder performance.
- b. When you reattach the hubQR after removing, make sure to use the correct method as shown to the right.
- c. If you use the correct method, it should slide in very smoothly, with minimal effort.
- d. Once the steering side and hub side mate, spin the wheel (any direction) until it locks firmly into position.
- e. Make sure the hubQR is locked in place before driving.
- f. Using the wrong method can result in poor performance or damage to the unit, which will not be covered under warranty as a product defect.
- g. Over time, the hubQR finish may remove at contact points but this is normal wear and tear.

Proper way to attach Rapfix II

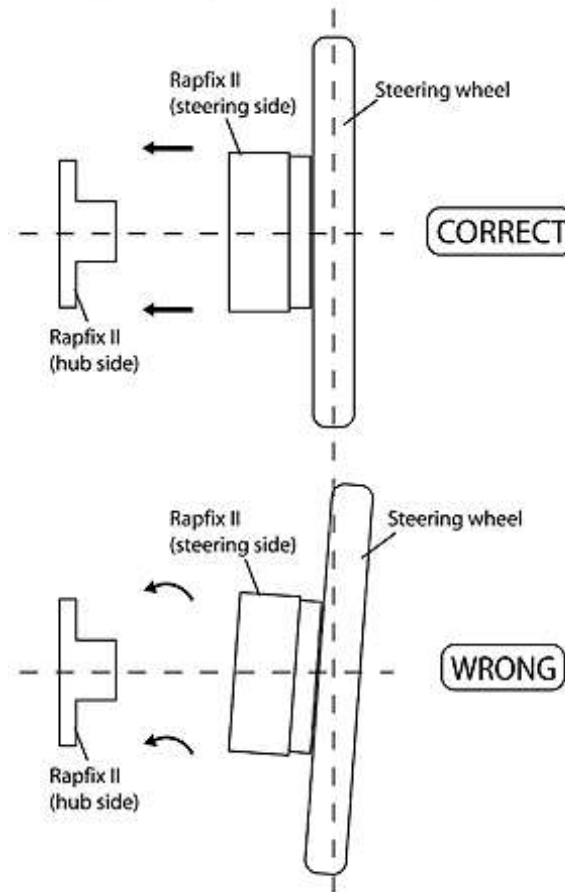

12. Using the Flipper

- a. There are two modes you can set for the Flipper.
- b. The first mode is "Safe Mode"

hubQR2 with SRS Module Installation Instructions Rev C		Rev. B	Page 9 of 10
Assembly Step	Tools/ Parts	Detailed Instructions	Picture

		<p>and requires you to manually press the button on the side of the hubQR</p> <p>c. The second mode is “Quick Release Mode” and allows you to remove your steering wheel by simply pulling back on the flipper.</p> <p>d. To put your Flipper from safe mode to quick release mode or visa versa, simply twist the flipper so that it lines up accordingly for the mode you wish to be in.</p>	
--	--	------------------------------------------------------------------------------------------------------------------------------------------------------------------------------------------------------------------------------------------------------------------------------------------------------------------------------------------------------------------------------------------------	--------------------------------------------------------------------------------------

Assembly Step	Tools/ Parts	Detailed Instructions	Picture
---------------	--------------	-----------------------	---------

